

REV.	ECN.NO.	APPD.
A	/	/

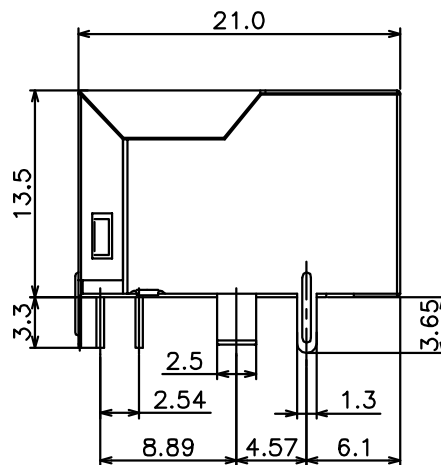
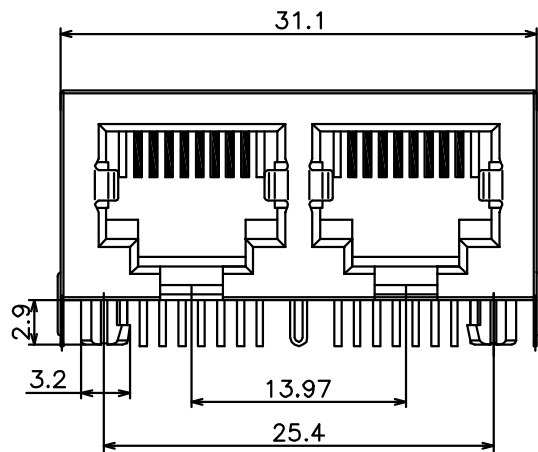

NOTES:

1.MATERIAL:

- 1.1 Housing: thermoplastic plastics
- 1.2 terminals: Copper Alloy
Gold plated in contact area:
OR Gold Plated overall

- 1.3 Shell: Steel&Copper Alloy
Nickel/Tin Plated overall

2.ELECTRICAL CHARACTERISTICS:

- 2.1 Rating Current :1.5 Ampere
- 2.2 Rating Voltage :125 V Max
- 2.3 Contact Resistance:50 Milli ohms
- 2.4 Insulation Resistance:500 Mega ohms Min.

3.MECHANICAL CHARACTERISTICS:

- 3.1 Connector Mating force: 2.27kgf MAX
- 3.2 Durability:750Cycles.

4.ENVIRONMENT CHARACTERISTICS:

- 4.1 Operating temperature: -40°C to +85°C
- 4.2 Storage temperature: -10°C to +40°C

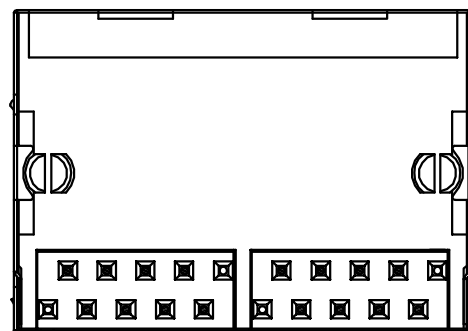

BOTTOM VIEW

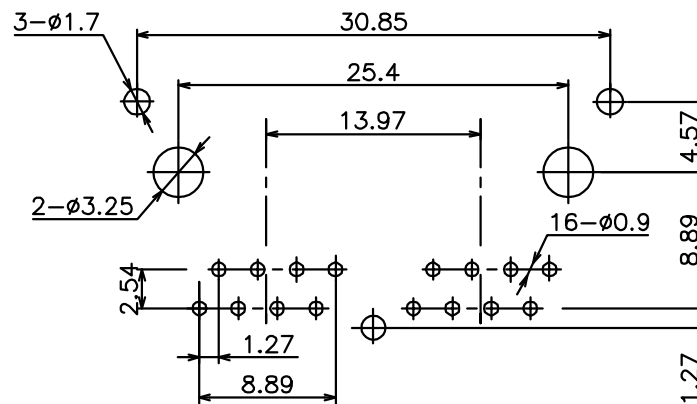

PCB LAYOUT (BOTTOM VIEW)
RECOMMENDED

R5F0-1151F-G31018

G: 半金G/FU" 1: 吸塑盒

3: PA46 1: 黑色

TOLERANCE UNLESS OTHERWISE SPECIFIED		HLW 深圳市华联威电子科技有限公司				
.XXX ±0.30 .XX ±0.20 .X ±0.10		.X' ±5' .XX' ±2'		HUA LIAN WEI TECHNOLOGY ELECTRONICS CO;LTD.		
APPROVED		PART NAME:	RJ45 1*2 无灯无弹21MM			
CHECKED		PART No:	R5F0-1151F-G31018	C		
DRAWN	Shen	PROJECTION:	UNIT:	SCALE	SHEET	REV.
DATE	2021.09.01		mm	1:1	10F1	A