

| REV. | ECN.NO. | APPD. |
|------|------------|-------------|
| A | XXXXXXXXXX | yangguifeng |

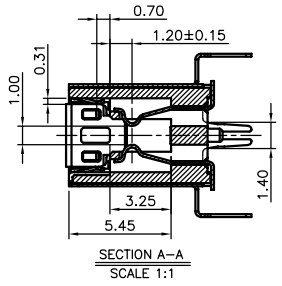

- NOTES:
- MATERIAL:
 - Housing:thermoplastic plastics
 - terminals:Copper Alloy
Gold plated in contact area:
Tin plated in termination
Nickel Plated overall
 - Shell:Steel&Copper Alloy
Nickel/Au Plated overall
 - characteristics:
 - Rating Voltage : 30V AC.
 - Rating Current:
5A for Vbus;1.25A for Vconn PIN
 - Contact Resistance:40 mΩ MAX.
 - Insulation Resistance:100 MΩ MIN.
 - Withstanding Voltage:AC 100V
 - Mating force: 5~20N MAX
 - Extraction force:8~20N Min
 - Life test:10000Cycles MIN.
 - Temperature Range: -30℃~+80℃.
- The product must be compliance ROHS

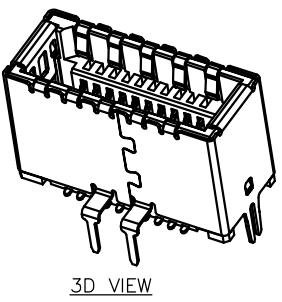
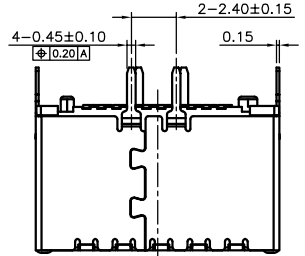
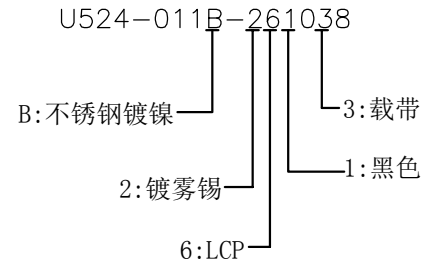
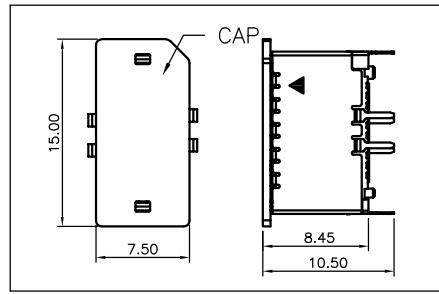
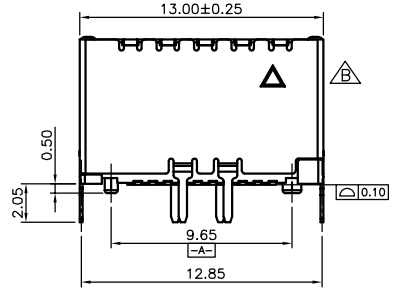
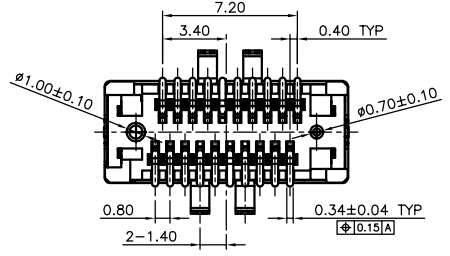
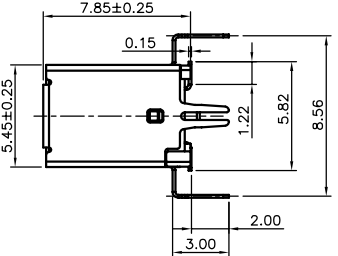
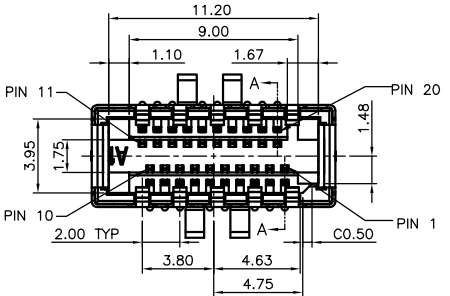

Pin Map to support one Type-C port

| | | | | | | | | | |
|------|------|------|------|------|------|-----|------|------|------|
| P11 | P12 | P13 | P14 | P15 | P16 | P17 | P18 | P19 | P20 |
| VBUS | TX2+ | TX2- | GND | RX2+ | RX2- | GND | D- | D+ | CC2 |
| SBU2 | SBU1 | CC1 | VBUS | RX1- | RX1+ | GND | TX1- | TX1+ | VBUS |
| P10 | P09 | P08 | P07 | P06 | P05 | P04 | P03 | P02 | P01 |

Pin Map to support two Standard-A ports

| | | | | | | | | | |
|------|-----|-----|------|------|------|-----|------|------|------|
| P11 | P12 | P13 | P14 | P15 | P16 | P17 | P18 | P19 | P20 |
| VBUS | | | GND | | | GND | D- | D+ | |
| | | | VBUS | RX1- | RX1+ | GND | TX1- | TX1+ | VBUS |
| P10 | P09 | P08 | P07 | P06 | P05 | P04 | P03 | P02 | P01 |

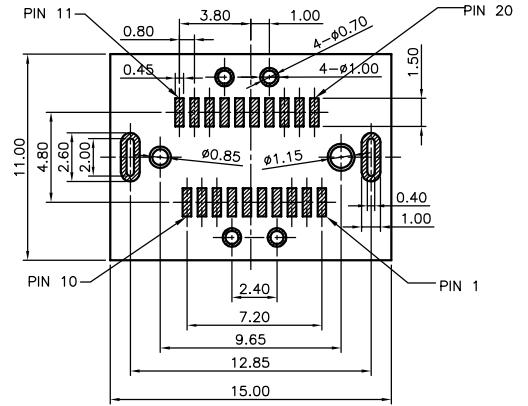

| | | | | | |
|--------------------------------------|-------------|---|-----------------------|-------|--------|
| TOLERANCE UNLESS OTHERWISE SPECIFIED | | FLW 深圳市华联威电子科技有限公司 | | | |
| .XXX ±0.10 .XX ±0.20 .X ±0.30 | | HUA LIAN WEI TECHNOLOGY ELECTRONICS CO;LTD. | | | |
| APPROVED | | PART NAME: | HDMI E TYPE 20P 立贴7.8 | | |
| CHECKED | | PART No: | U524-011B-261038 | C | |
| DRAWN | yangguifeng | PROJECTION: | UNIT: | SCALE | SHEET |
| DATE | 2021.12.01 | | mm | 1:1 | 1 OF 1 |