

| REV. | ECN.NO. | APPD. |
|------|---------|-------|
| A | / | / |

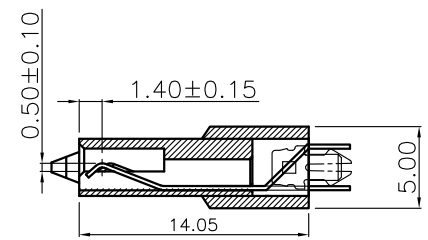
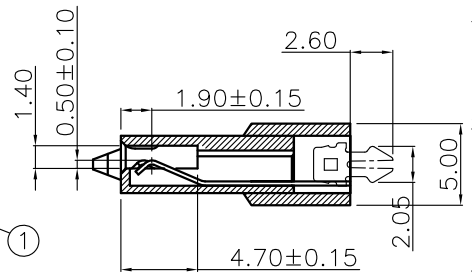
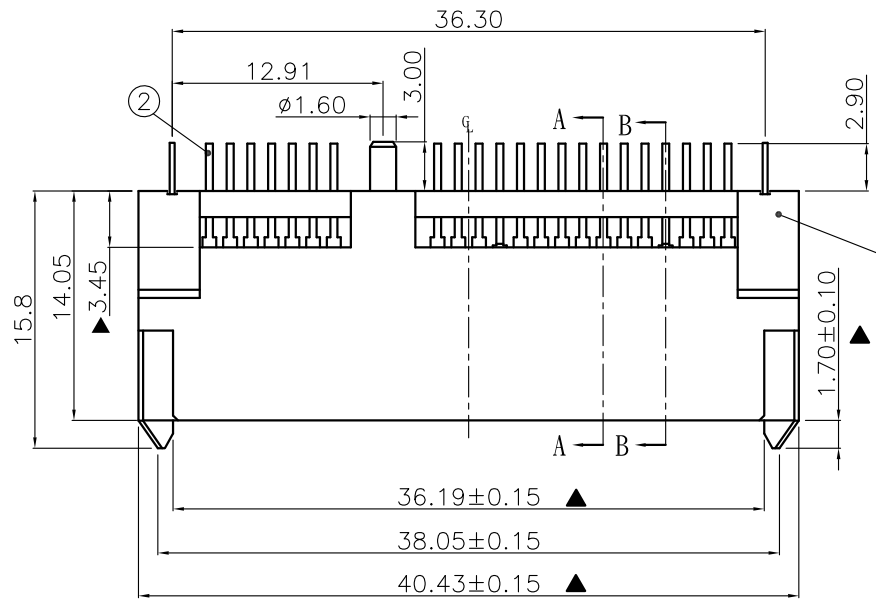

NOTE:

- MATERIAL:
HOUSING: LCP WITH 30% GF, UL 94V-0, BLACK COLOR.
CONTACTS: PHOSPHOR BRONZE.
BOARDLOCKS: BRASS.
- FINISH:
CONTACTS: GOLD FLASH PLATED ON CONTACT AREA, [100μ"] MIN..
BRIGHT-TIN ON SOLDER TAIL, WITH ENTIRE CONTACT UNDERPLATED [50μ"] MIN.. NICKEL.
BOARDLOCKS: [100μ"] MIN. BRIGHT-TIN OVER[50μ"] MIN. NICKEL ON ENTIRE BOARDLOCK.
- PART NUMBER DESCRIPTION :

ST21-0740-G618

G: 镀半金G/Fu"
1: 黑色
6: LCP

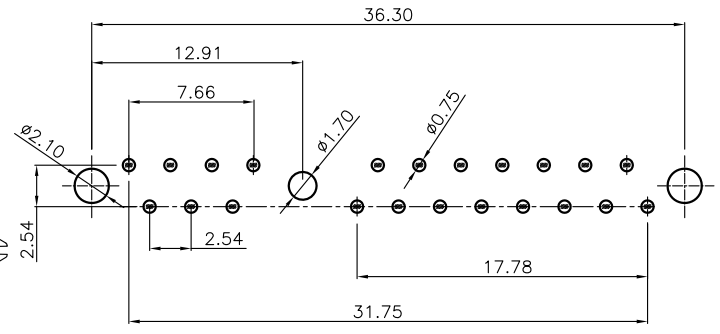
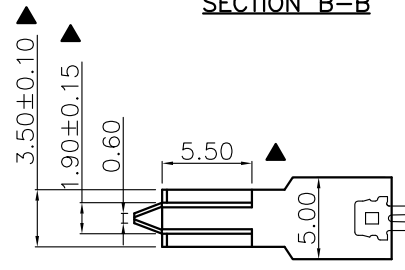
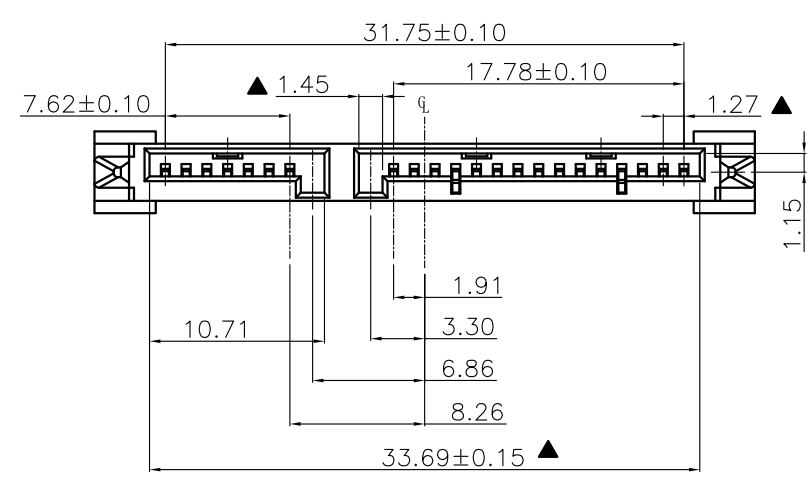

RECOMMEND PCB LAYOUT (T=1.6)
PCB TOLERANCE: ±0.05

| TOLERANCE UNLESS OTHERWISE SPECIFIED | |
|--------------------------------------|----------|
| .XXX ±0.10 | .X' ±3' |
| .XX ±0.20 | .XX' ±2' |
| .X ±0.30 | |

FLW 深圳市华联威电子科技有限公司
HUA LIAN WEI TECHNOLOGY ELECTRONICS CO;LTD.

| | | | | | | |
|----------|-----------|-------------|----------------------------------|-------|-------|------|
| APPROVED | | PART NAME: | SATA 7+15P 双排180度DIP L=15.8带柱鱼叉脚 | | | |
| CHECKED | | PART No: | ST21-0740-G618 | C | | |
| DRAWN | weihong | PROJECTION: | UNIT: | SCALE | SHEET | REV. |
| DATE | 2021.9.23 | | mm | 1:1 | 10F1 | A |