

REV.	ECN.NO.	APPD.
A0	/	/

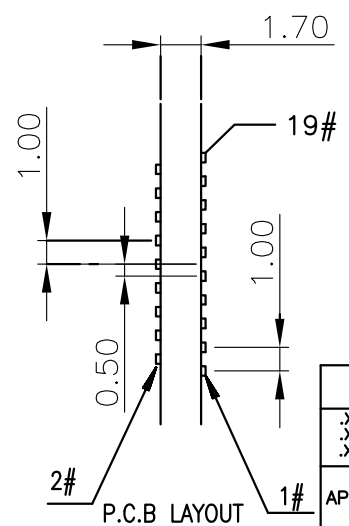
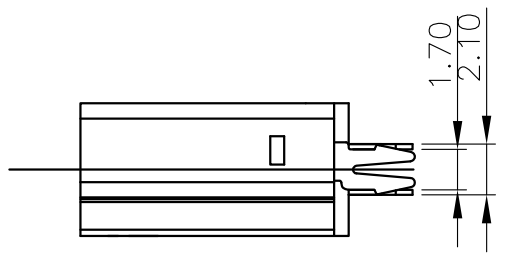
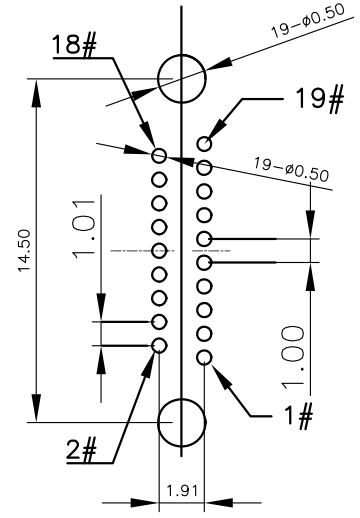
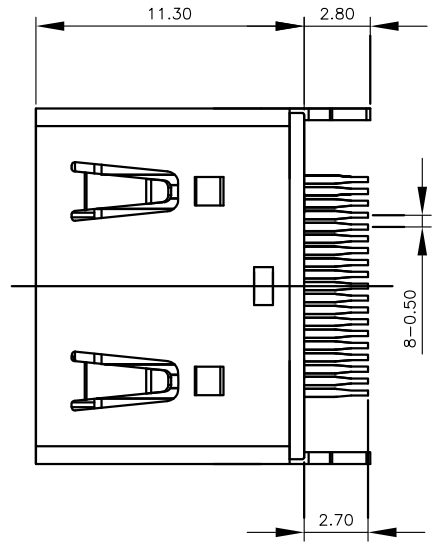
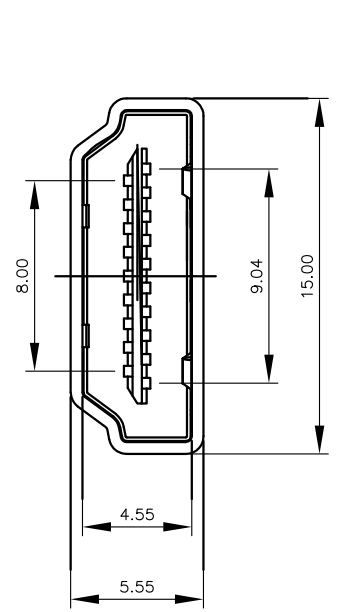

NOTES:

- 1.MATERIAL:
  - 1.1 Housing:thermoplastic plastics
  - 1.2 terminals:Copper Alloy  
Gold plated in contact area:  
Tin plated in termination  
Nickel Plated overall
  - 1.3 Shell:Steel&Copper Alloy  
Nickel/Au Plated overall
- 2.ELECTRICAL CHARACTERISTICS:
  - 2.1 Rating Current :0.5 Ampere
  - 2.2 Rating Voltage :40 V Max
  - 2.3 Contact Resistance:30 Milli ohms
  - 2.4 Insulation Resistance:100 Mega ohms Min.
- 3.MECHANICAL CHARACTERISTICS:
  - 3.1 Connector Mating force: 4.5kg MAX
  - 3.2 Connector Unmating force:1.0Kg min
  - 3.3 Durability:10000Cycles.
- 4.ENVIRONMENT CHARACTERISTICS:
  - 4.1 Operating temperature:-20℃ to +85℃
  - 4.2 Storage temperature:-20℃ to +65℃

HD26-0235-G61118  
 5:铜壳镀镍  
 G:半金G/Fu”  
 1:吸塑盒  
 1:黑色  
 6:LCP

TOLERANCE UNLESS OTHERWISE SPECIFIED	
.XXX ±0.10	.X' ±3'
.XX ±0.20	.XX' ±2'
.X ±0.30	

**FLW** 深圳市华联威电子科技有限公司  
 HUA LIAN WEI TECHNOLOGY ELECTRONICS CO;LTD.

APPROVED		PART NAME:	HDMI 19P/F 180° 直插镍 H款			
CHECKED		PART No:	HD26-0235-G61118	C		
DRAWN	weihong	PROJECTION:	UNIT:	SCALE	SHEET	REV.
DATE	2021.03.06		mm	1:1	10F1	A0