

REV.	ECN.NO.	APPD.
A	/	ZFY

NOTE:

- MATERIAL:
HOUSING: LCP WITH 30% GF, UL 94V-0, BLACK COLOR.
CONTACTS: PHOSPHOR BRONZE.
BOARDLOCKS: BRASS.
- FINISH:
CONTACTS: GOLD FLASH PLATED ON CONTACT AREA, [100μ"] MIN..
BRIGHT-TIN ON SOLDER TAIL, WITH ENTIRE CONTACT UNDERPLATED [50μ"] MIN.. NICKEL.
BOARDLOCKS: [100μ"] MIN. BRIGHT-TIN OVER[50μ"] MIN. NICKEL ON ENTIRE BOARDLOCK.

5. PART NUMBER DESCRIPTION :

ST22-0240-G618

G: 镀半金G/Fu" 1: 黑色
6: LCP

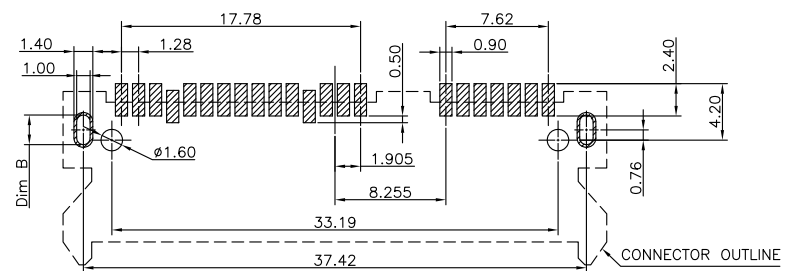
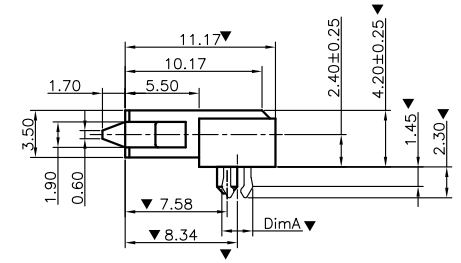
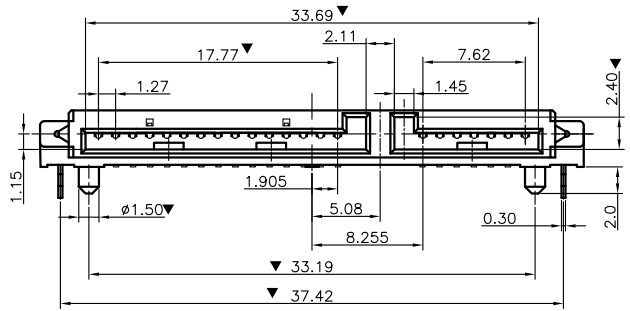
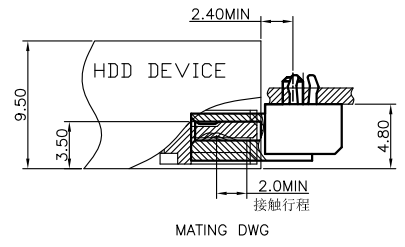
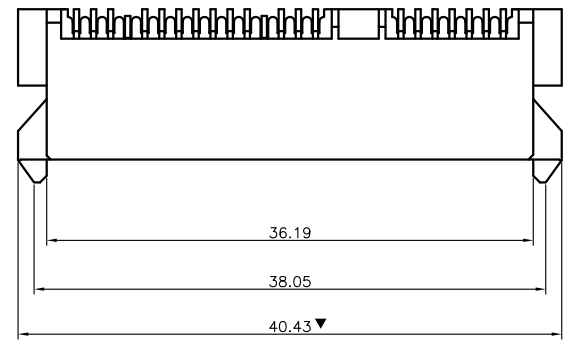

TOLERANCE: ±0.05
RECOMMENDED PCB LAYOUT
(TOP VIEW)

Table A

RSF-C300-B22L1T-L01	2.08	2.30	01
PART NO.	DIM B P.C.BOARD	DIM A CONNECTOR	ITEM

TOLERANCE UNLESS OTHERWISE SPECIFIED		FLW 深圳市华联威电子科技有限公司 HUA LIAN WEI TECHNOLOGY ELECTRONICS CO;LTD.			
.XXX ±0.15	.XX ±0.20	.X ±0.30	.X* ±5°	.XX* ±2°	
APPROVED		PART NAME:	SATA 7+15P SMT H=4.2mm 板上SMT无凸2.08孔鱼叉脚		
CHECKED		PART No:	ST22-0240-G618	C	
DRAWN	yanggufieng	PROJECTION:	UNIT:	SCALE	SHEET
DATE	2021.10.20		mm	1:1	10F1
				REV.	A